

Transition Academy

Employment of Youth

Sponsored by:



Thursday, November 29, 2012

Chula Vista Resort

Wisconsin Dells, WI

General Information



Please visit the computer lab in **Presidential Suite #3001** to review information on two new Wisconsin Transition Websites. The wsti.org and tr4y.org websites provide enhanced transition practices and resources to assist with your transition needs.

Cell Phones: As a courtesy to our presenters and participants, we ask that all cell phones be silenced during the academy. Thank you for your cooperation!

Handouts: Extra handouts from concurrent sessions will be placed on a table in the registration area. Handouts for all academy sessions will be posted at www.wsti.org

Coat Rack will be available near the registration area.

Lost and Found items can be turned in or picked up at the registration table.

Academy Emergency Phone Number: In the event you need to be reached at the academy, the number for the Chula Vista front desk is 608-254-8366. Messages from the front desk will be announced in the general session or at lunch.

Photo Release Statement: From time to time we use photographs of academy participants in our promotional materials and on the Wisconsin Statewide Transition Initiative (WSTI) website. By virtue of your attendance at the Transition Academy, WSTI reserves the right to use your photo in such materials. If you prefer NOT to have your photo utilized, please stop by the registration table to notify us.



**8:30 AM - 9:00 AM Welcome & Opening Announcements
Riverview Room North & South**

**9:00 AM—10:00 AM Keynote Speakers
Mike Berkson and Tim Wamback from “Handicap This”**

You will not want to miss this dynamic duo full of laughs and a wealth of information that will change your perspective!



10:15 AM—11:30 AM CONCURRENT SESSIONS ~ BLOCK 1

Session 1: Resources, Programs, and Tips for People on the Autism Spectrum Planning for Post Secondary Education.

Presenter: Daniel Parker

Sante Fe 3010

Planning for post secondary education is a daunting task for anyone and requires years of planning and preparation. This session will provide insight into post secondary planning for students that identify with the social /communication /organizational needs specific to autism. We will take a look at the resources that post secondary programs currently offer to assist with these needs as well as examples and ideas for curriculum that can help prepare students early on for the challenges ahead.

Session 2: Work Based Learning Options for High School Students

Presenter: Sara Baird

Santa Fe 3016

One of the many goals of education is to prepare students to successfully enter the workforce. A strong academic, career and technical foundation and preparation for career opportunities are important educational components for Wisconsin students. Students can benefit from participation in educational programs that provide a work-based experience and a more deliberate selection of course work based on potential career interests. Find out about CTE programs like school based enterprises, service learning, employment skills certificate program, job shadowing, youth apprenticeships, and much more!

Session 3: Disability Disclosure**Presenters: Andrew Berlin and Rhonda Lewan Santa Fe 3020**

Knowing when to disclose a disability is a difficult decision. In this session learn what the ADA says, how it applies in the “real world” and determine the pro’s and con’s from one situation to another. Local and national case examples will be shared, including how to facilitate self-advocacy.

Session 4: Approaching Employers**Presenter: Michelle Uetz Room A**

This presentation will help answer the question, "What do I say to employers?" Often job development doesn't happen because we don't know how to approach employers. As the wife of a business owner, I have a unique perspective from which to approach employers. I have had success in placing several students in work experiences and job shadows in a small town with College students to compete against. Materials will be shared.

Session 5: Wisconsin Let’s Get to Work: A Policy and Practice Approach to Launching Youth with Disabilities Into the Workforce**Presenter: Jenny Neugart Room B**

This session provides an overview of one of six state Projects of National Significance systems change grants to improve competitive employment outcomes for youth/young adults with intellectual and developmental disabilities. “Let’s Get to Work” focuses on policies and practices to improve employment outcomes for youth with developmental disabilities using 3 main strategies: a consortium of stakeholders, school pilots that implement practice, and coaches that train/mentor at the local level, resulting in local, state, and national policy and practice systems change. Participants will leave this session with an overview of the Wisconsin Let’s Get to Work project, including a better understanding of: 1) how to implement evidence-based practices at the local level and systemically; 2) policy barriers that impact employment; and 3) practical strategies for engaging policy makers in systems change.

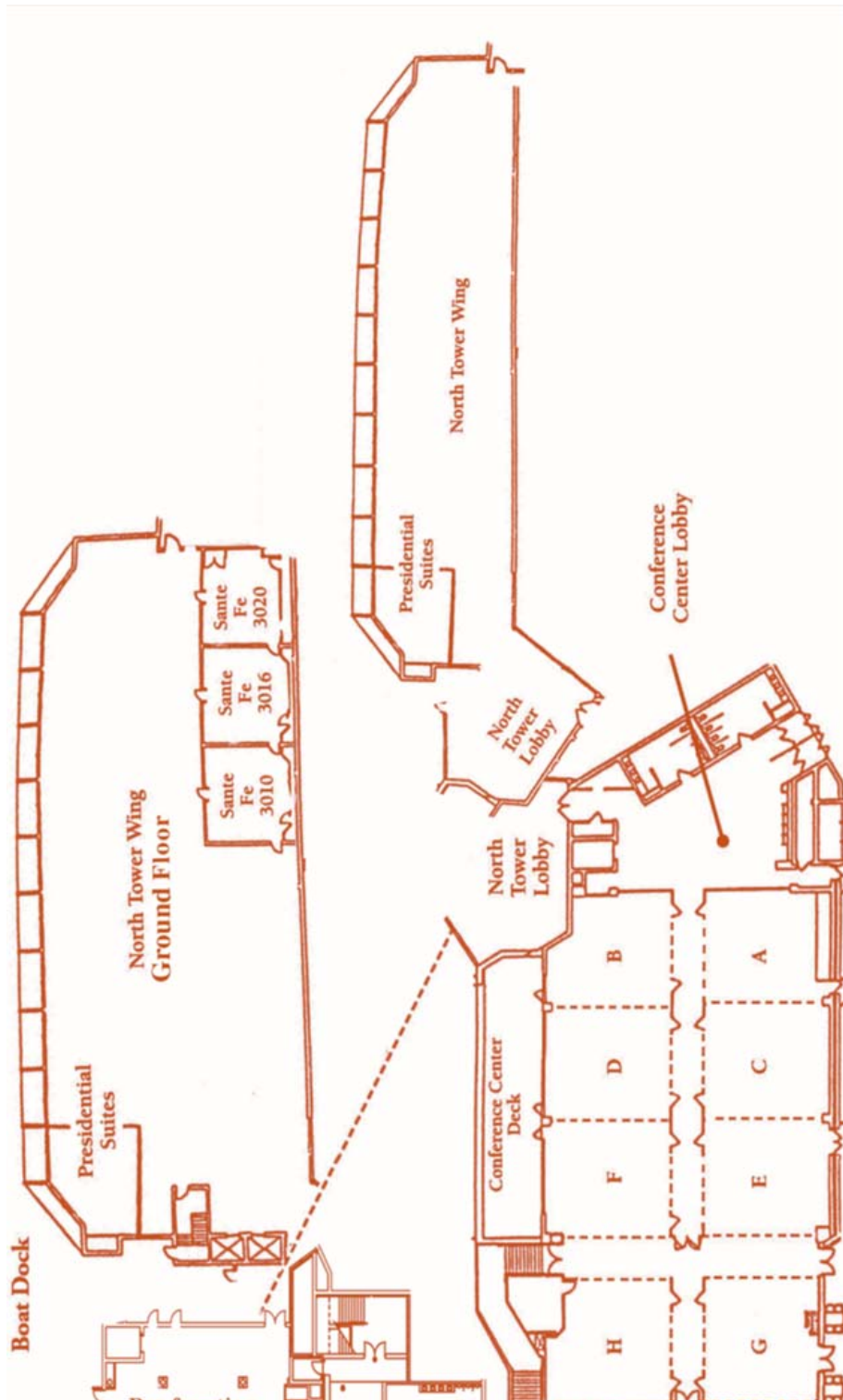

10:15 AM-11:30 AM CONCURRENT SESSIONS ~ BLOCK 1

Session 6: Employment is Possible

Presenters: Jessica Thompson, Sarah Lincoln, Tammy Hofmeister, John O'Keefe, Neal Minogue and Ellie Hartman **Room C**

This panel presentation will include experts familiar with Long Term Care Employment including Aging and Disability Resource Centers, Children's Long Term Care, IRIS, Managed Care/Family Care and Employment Data. We will be discussing all the ways that employment is possible and supported through the State's Long Term Care Programs starting at Transition. Data will also be presented to explain the current status employment for people with disabilities around the State. This is a great opportunity to get your questions answered on Employment in Long Term Care in Wisconsin.

Session 7: Reality Bites: Living In An Adult World

Presenters: Laura Plummer & Cindi Pichler **Room D**

The students are ready to graduate. You have done your job. They are ready. Right? Well, not so fast. This session will walk us through the differences between high school and the real world. Whether it's transitioning to school or work, students need to be given the tools that they will need to succeed. There are three deadly accommodations which are provided in K-12 that are not part of the real world. Explore these accommodations, plus more and learn how to prepare your students as they become full-fledged adults.

11:30 AM-12:30 PM LUNCH Riverview Room North & South

12:30 PM-1:45PM CONCURRENT SESSIONS ~ BLOCK 2

Session 8: Adults on the Autism Spectrum: Finding Employment That Works

Presenter: Youth Panel **Sante Fe 3010**

Unemployment in adults with autism is high, even higher than in many other disability populations. Hear from a panel of young adults with autism spectrum disorders about their experiences with searching for work, volunteer work, and paid employment.

Session 9: New Child Labor Law Guide**Presenter: Jim Chiolino****Sante Fe 3016**

This presentation will provide participants with knowledge of the new child labor law guidelines, work permits, liability and insurance obligations, youth hour and wage guidelines and employment restrictions for students under the age of 18 that you are working with. This is a must see presentation you will not want to miss!

Session 10: Authorizing Supported Employment Job Coaching for Family Care, Partnership and PACE Members**Presenter: Tammy Hofmeister****Sante Fe 3020**

This session discusses the Resource Memo sent out by DHS to Managed Care Organizations about how to authorize supported employment job coaching for Family Care, Partnership and PACE members. This memo is intended to offer best practice guidance for MCO staff to authorize supported employment job coaching. The memo outlines the principles and questions to ask when looking to authorize job coaching. A sample job coaching progress report is included in the memo.

Session 11: Skills to Pay the Bills**Presenter: Pam Jenson****Room A**

Join this session to learn more about ODEP's [Skills to Pay the Bills](#) curriculum developed to assist youth in strengthening essential skills needed to succeed in today's workforce. Activities and videos will be incorporated in this session.

Session 12: An Individualized Approach to Providing Access to Employment for Students With Significant Disabilities**Presenter: Edward Sheehy****Room B**

This presentation will discuss strategies for individualizing the employment relationship between employees and employers in ways that meet the needs of both. Strategies for identifying individualized strengths, needs, and interests of individuals with significant disabilities and employer specific needs will be addressed. Examples of successes will be provided.

Jen Bourget, WSTI Coordinator

CESA #1

N25 W23131 Paul Rd., Pewaukee, WI 53072

Office: 262-794-3351

jenb@wsti.org

Pam Jenson, WSTI Coordinator

CESA #2

1221 Innovation Drive, Suite 205, Whitewater, WI 53190

Office: 608-921-1400

pamj@wsti.org

Jen Ledin, WSTI Coordinator

CESA #12

618 Beaser Avenue, Ashland, WI 54806

Office: 715-682-2363, Ext. 149

jenl@wsti.org

Dave Nass, WSTI Coordinator

CESA #8

223 W. Park St., Gillet, WI 54124

Office: 920-855-2114, Ext. 250

daven@wsti.org

Mary Kampa

Director of the Wisconsin Post High Outcomes Survey

CESA #10

725 West Park Ave., Chippewa Falls, WI 54729

Office: 715-416-0609

maryk@wsti.org

Wendi Dawson

WSTI Grant Liaison, Special Education Team

Wisconsin Department of Public Instruction

125 South Webster Street, Madison, WI 53703

Office: 608-266-1146

wendi.dawson@dpi.wi.gov

Session 19: Systematic Instruction: Teaching in Employment Settings**Presenter: Ryan Schultz****Room B**

This presentation will discuss the balance of providing systematic instruction and facilitating natural supports for student success on the job. It will redefine the role of the job coach to facilitator while actively involving work-site personnel (natural supports) and provide strategies for on the job instruction to young adults.

Session 20: Creating Employment Goals with Career Clusters and Pathways**Presenters: Wendi Dawson and Sara Baird****Room C**

The new Postsecondary Transition Plan (PTP) application utilizes the Wisconsin Career Clusters and Pathways in the creation of measurable postsecondary goal in the area of Employment. This session will focus on strategies and resources available to familiarize special educators with the Clusters and Pathways.

Session 21: Building Work Skills in Educational Settings**Presenters: Beloit, Burlington and Stoughton School Districts****Room D**

Meet this panel of educators that will provide you with the ins and outs of how to teach work skills through the inclusion process; as well as set up, organize and maintain a school based business. This session will also provide creative ideas for school based businesses to meet the needs of your school and communities.

Session 13: Working, Learning and Becoming an Independent Young Adult**Presenter: Nicole Borley****Room C**

Bridging the gap for students with disabilities to develop employment skills to help become independent employees is the key. Students work through a transition matrix that allows students to learn through job coaching, internal paid work experiences, and community paid work experiences. Pulaski High School staff will share the process of helping students prepare for post secondary employment and educational opportunities. Staff and students will share job experiences and talk about self-advocacy skills they have gained through the process.

Session 14: Making Connections and Creating Effective Community Based Programs to Serve 18-21 Year Old Students With Disabilities**Presenter: Steve Gilles****Room D**

18-21 year old transition programs for students with disabilities provide opportunities for students to gain independent living, social, employment and self-advocacy skills in real-life settings and to participate in age-appropriate activities in their communities. This presentation will share the Community Services Option (CSO) & Community Advantage Program (CAP) guides, which are tools to assist local districts in assessing needs and developing transition-focused programs within a community-based environment. These guides also assist districts to create a step-by-step process to identify student need, analyze in school and community resources, set priorities, and develop meaningful action plans.



Session 15: Natural Supports for Individuals on the Autism Spectrum in the Workplace

Presenters: Jen Bourget, Holly Lee and Chris LeRose

Santa Fe 3010

Learn about natural supports in the workplace that focus on students on the Autism Spectrum in this session. Teachers and parents will learn about resources and strategies for implementing appropriate accommodations and modifications in work environments. Successful employment for students on the spectrum is our main focus in this breakout session! A representative from the Wisconsin Independent Life College will also be a part of this session to talk about this new opportunity for students with Autism to go on to a post secondary setting. Students from the college will be available to answer questions about their experiences and how they use Rapid Prompting Method to communicate in employment settings.

Session 16: ABC's of Job Development, Coaching & Supports

Presenter: Brian Kenney

Santa Fe 3016

This sectional will provide a checklist and guidelines to those who are looking to develop possible job sites for students with disabilities. It will include information on the following :

1. Job development - from the first connection with employer to the first day of work and filling out HR paperwork
2. Aspects of coaching - charting progress, differentiation, teaching soft job skills and how to correct mistakes that are made at work and work with the employer to be a strong coach.
3. Finding supports in the work place - eventually a time will come when the coach will have to move out slowly and supports on the work site will have to be identified. This is the most important transition that takes place. How to forecast the slow exit plan - (fading out of a coach).

Session 17: Vocational Futures Planning and Support

Presenter: Dan Johnson

Santa Fe 3020

In this session you will learn about Vocational Futures Planning and Support (VFPS), the efforts to expand this service in Wisconsin and where to access more information and advanced training on VFPS services. The VFPS model was highlighted by the National Technical Assistance and Research Center to Promote Leadership for Increasing Employment and Economic Independence of Adults with Disabilities (NTAR) as an example of “state innovations and best practices for using Medicaid to promote positive employment outcomes.” VFPS provides an effective framework to help youth and young adults with physical disabilities develop career options and self-advocacy skills for life after high school.

Session 18: Employment First Wisconsin

Presenter: Nancy Molfenter

Room A

Employment First is a national movement to support the attainment of integrated employment by individuals with disabilities. Such support comes in a variety of forms such as helping students with disabilities and their family members understand that integrated employment is an option; assisting educators to learn about practices in transition that are more likely to lead to integrated employment post-high school; connecting people with disabilities to potential employers through job tours, informational interviews, and work experiences; and advocating for policy and practice shifts to make employment in the community the first and preferred outcome for all people with disabilities. There is an Employment First Initiative in Wisconsin with a policy team and multiple groups forming around the state to work toward these goals at local and regional levels.